



34 Waterside, Hythe SO45 6AB

£119,950

paul jeffreys



34 Waterside, Hythe

A ONE BEDROOM FLAT WITH DISTANT SEA VIEWS IDEAL FIRST TIME PURCHASE OR INVESTMENT

Within short walk of Hythe village centre.

Double glazing, gas central heating (communal boiler), in need of modernisation. NO CHAIN.

ACCOMMODATION

Lounge, kitchen/diner, bedroom, bathroom

LOUNGE c.3.58m x 3.51m (11'9" x 11'6"). Wooden front door, radiator, TV point, front aspect window, opening to:

DINING AREA c.2.87m x 2.03m (9'5" x 6'8"). Space for dining table with opening to:

KITCHEN AREA c.2.03m x 1.85m (6'8" x 6'1"). Range of base units with cupboards and drawers, space for appliances, worktops, sink unit, tiled splashbacks, range of wall cupboards.

BEDROOM c.3.18m x 2.92m (10'5" x 9'7"). Radiator, cupboard space, front aspect window.

BATHROOM WC, wash hand basin, bath with 'Triton' electric shower, fully tiled walls, access to loft space, side aspect window.

OUTSIDE There is an area of communal gardens.

COUNCIL TAX BAND 'A' - payable 2025/26 - £1,560.89.

EPC RATING 'D'.

GROSS SQUARE MEASUREMENTS 38.7 sq. metres (416.7 sq. feet) approx.

TENURE The Agents are advised this property is LEASEHOLD with the residue of 125 year lease from 25.12.1991. The maintenance charge is £2,390.08 per annum. Includes buildings insurance, maintenance and gas for communal boiler. GROUND RENT £150 pa, £300 from 2041, £600 from 2066 and then £900 pa for the residue of the term.

DIRECTIONS Leave Hythe via Prospect Place and at the mini roundabout take 2nd exit towards the marina, turning left into West Street following the sharp left hand bend and turn 1st right into Waterside and the block is the first one on the right hand side.

NOTE PAUL JEFFREYS HAVE NOT TESTED ANY APPLIANCE MENTIONED IN THESE PARTICULARS, INCLUDING CENTRAL HEATING AND SERVICES AND CANNOT CONFIRM THAT THEY ARE IN WORKING ORDER. ALL PHOTOGRAPHS ARE FOR GUIDANCE AND ITEMS WITHIN THE PHOTOGRAPHS MAY NOT BE INCLUDED IN THE SALE. THE GAS BOILER IS COMMUNAL AND THE GAS IS INCLUDED IN THE MAINTNANCE CHARGE.

NOTE FLOOR PLAN IS FOR GUIDANCE ONLY

VIEWING STRICTLY BY APPOINTMENT – OPEN 7 DAYS A WEEK

MJD/HC/09.25

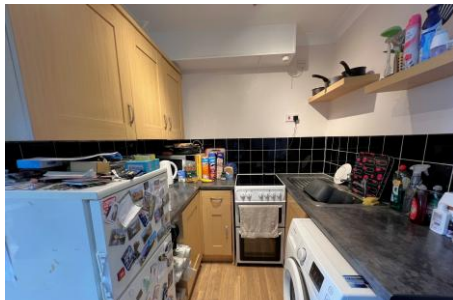

Second Floor

Approx. 38.7 sq. metres (416.7 sq. feet)

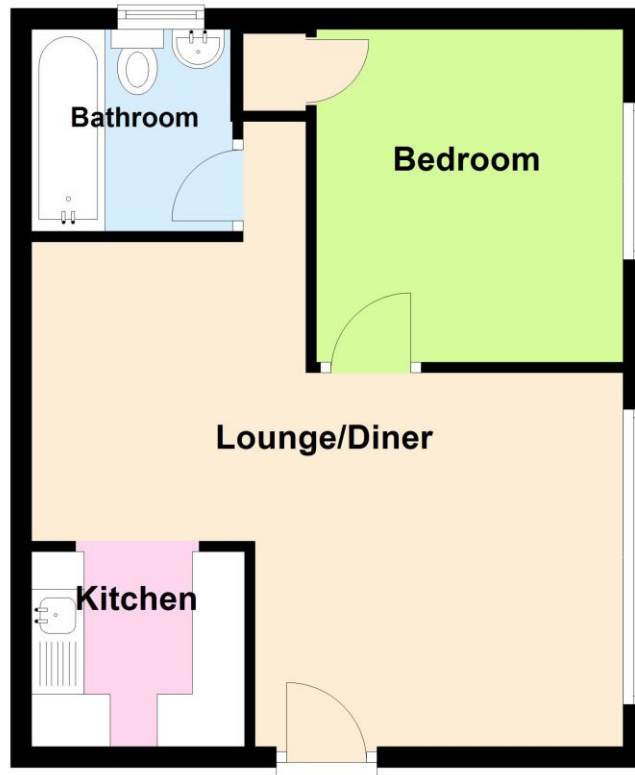

Total area: approx. 38.7 sq. metres (416.7 sq. feet)

IMPORTANT: we would like to inform prospective purchasers that these sales particulars have been prepared as a general guide only. A detailed survey has not been carried out, nor the services, appliances and fittings tested. Room sizes should not be relied upon for furnishing purposes and are approximate. If floor plans are included, they are for guidance only and illustration purposes only and may not be to scale. If there are any important matters likely to affect your decision to buy, please contact us before viewing the property.

independent estate agents

023 8084 8555

sales@pauljeffreys.co.uk

pauljeffreys.co.uk

Zoopa.co.uk

rightmove.co.uk
The UK's number one property website

paul jeffreys

Sales | lettings | land

Open 7 Days

 Paul Jeffreys Estate Agents

 @pauljeffreys92